

#2-B1A 8'-6" GLIDE-OUT (102") RAISED FLOOR 30" EXTENSION

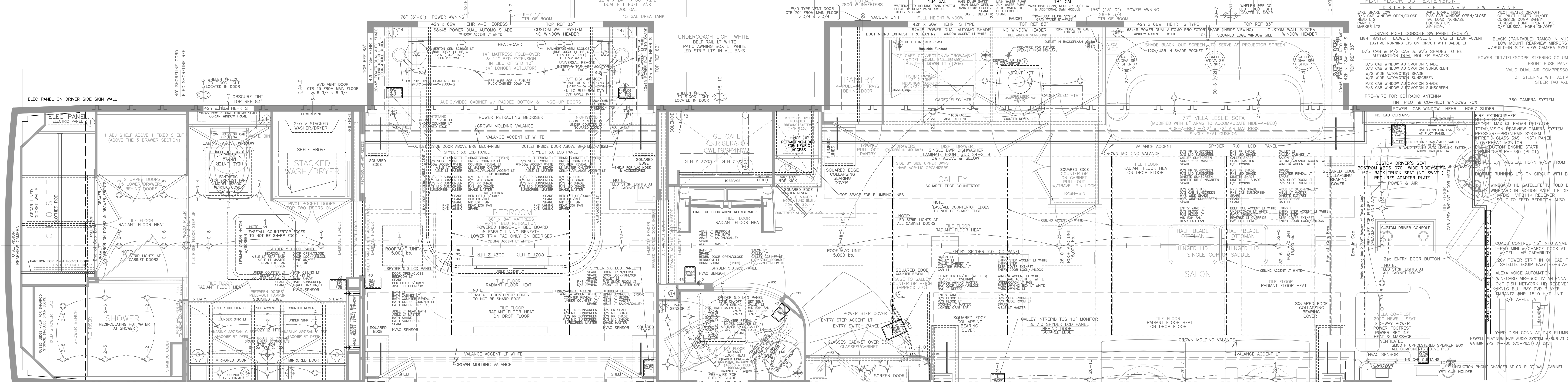

#1-B2A 15'-7" GLIDE-OUT (187") FLAT FLOOR 30" EXTENSION

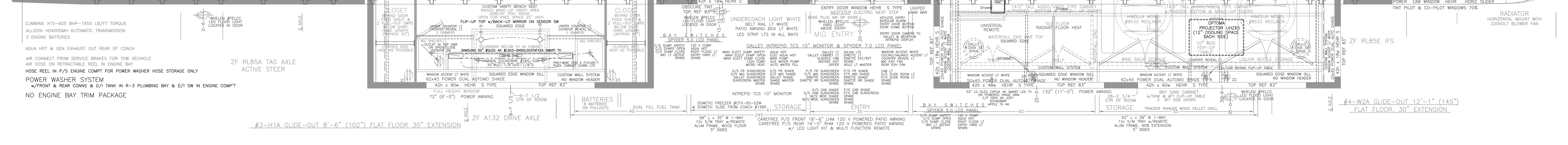

#3-H1A GLIDE-OUT 8'-6" (102") FLAT FLOOR 30" EXTENSION

#4-W2A GLIDE-OUT 12'-1" (145") FLAT FLOOR 30" EXTENSION

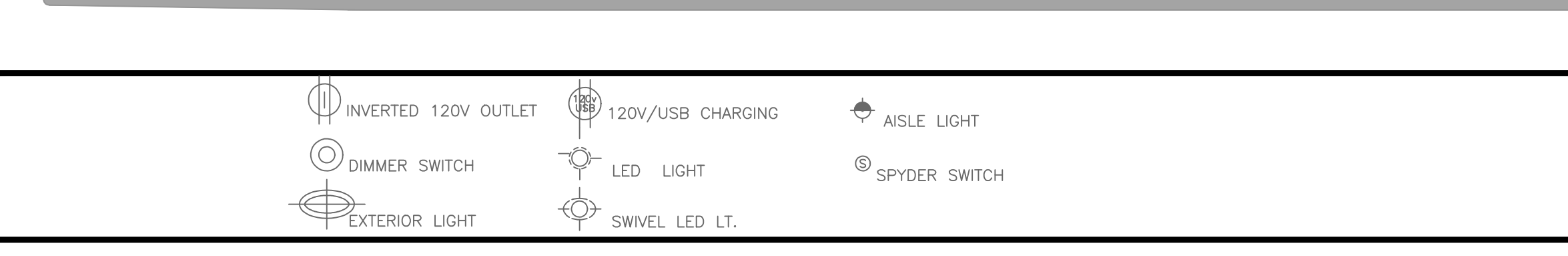
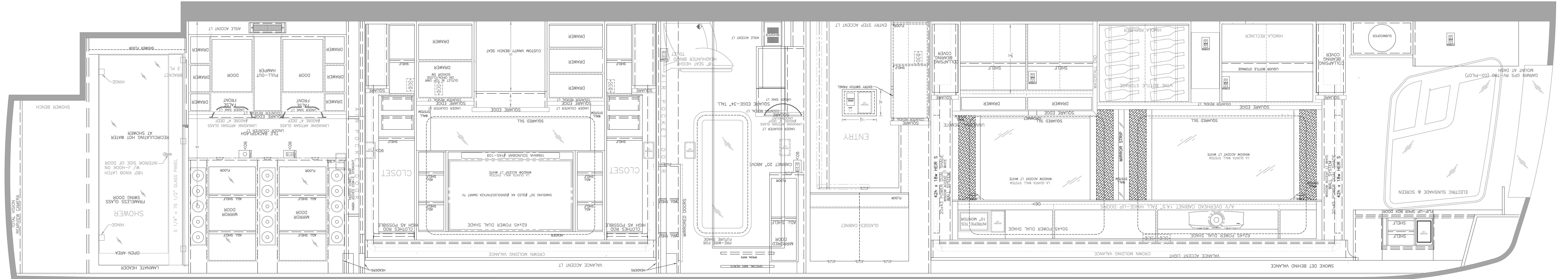

**SPECIAL OPTIONS AND DETAILS:**  
"BLOCK" CEILING DESIGN w/EXTRA PADS FOR CEILING ACCENT LT  
"CROWN" VALANCES  
*CHANGES & MODIFICATIONS*

CHASSIS DWG 12/17/20  
SKIN DWG 01/11/21  
ELECT DWG 01/26/21  
FLOORPLAN 02/04/21  
ELEVATION 02/11/21

SCHEDULED START DATE	01/31/21
SCHEDULED TO LEAVE CABINET	04/28/21
ESTIMATED COMPLETION	06/29/21

NEVELL COACH CORP.  
3900 NORTH MAN ST.  
MAM, OKLAHOMA 74554  
PH (918)423-3344 FAX (918)423-2098

BY: *Richard A.* DATE: 01/15/21 REVISED: ENGINEERING COORDINATOR:  
VIN: 1N9462X81N101730 SCALE: 1"=1' MODEL: P50 308" WHEELBASE  
DESIGN FOR: