

#2 ROOM...#3-H1A GLIDE-OUT (8'-6\"/>

#1-B2A 15'-7\"/>

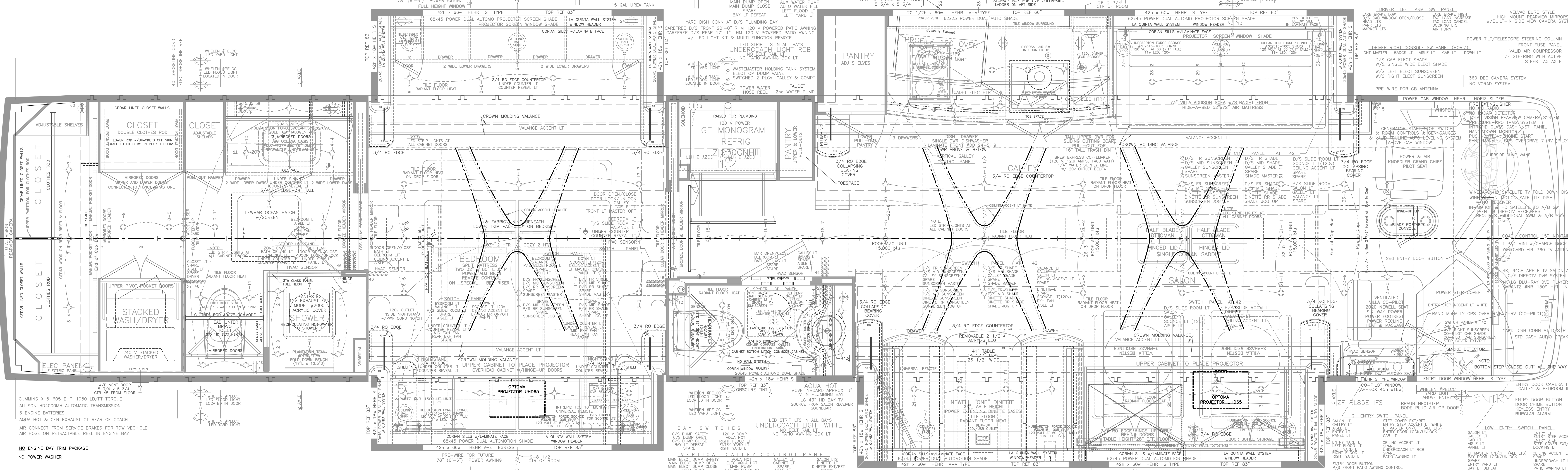

#3 ROOM...#2-C1A (8'-6\"/>

#4-OP2A GLIDE-OUT 13'-7\"/>

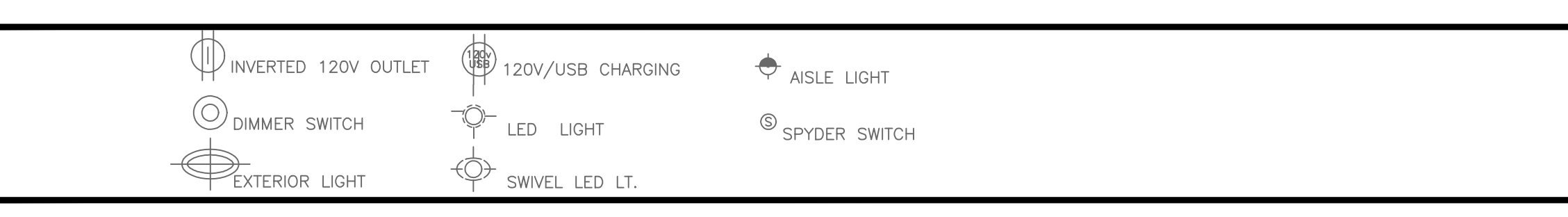
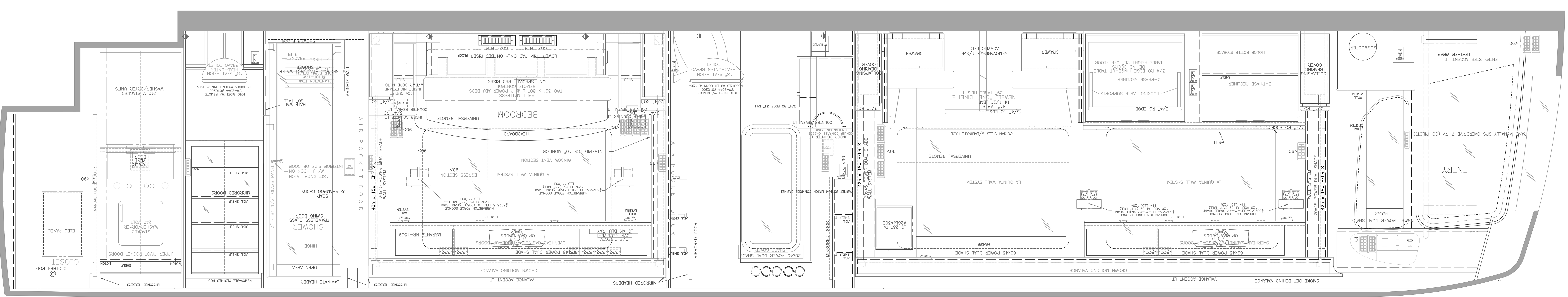

NOTES:

"CROSSPOINT" CEILING DESIGN w/ACCENT LIGHTING NO SLIDE-OUT ROOM CEILING PONDS

CHASSIS DWG 12/17/18	SCHEDULED START DATE	01/10/19
SKIN DWG 01/07/19	ESTIMATE TO PAINT	04/18/19
ELECT DWG 01/22/19	ESTIMATED COMPLETION	05/28/19
FLOORPLAN 01/22/19		
ELEVATIONS 02/04/19		
ELEVATIONS 07/01/19		

BY: Richard A. DATE: 12/10/18 REVISION: 1

V.L.N.: 1N9458XB8L101680 SCALE: 1/4" = 1'-0" MODEL: P50

DESIGN FOR: NEVELL COACH CORP. 3900 NORTH MAIN ST. OKLAHOMA 74554 P.O. BOX 334 FAX (918)542-2088

ENGINEER: JAMES NEAHERY 302" WHEELBASE

#1680